

ILLINOIS STATE GEOLOGICAL SURVEY
 ROAD MATERIALS RESOURCES
 OF
 IROQUOIS COUNTY

NOV. 1, 1930

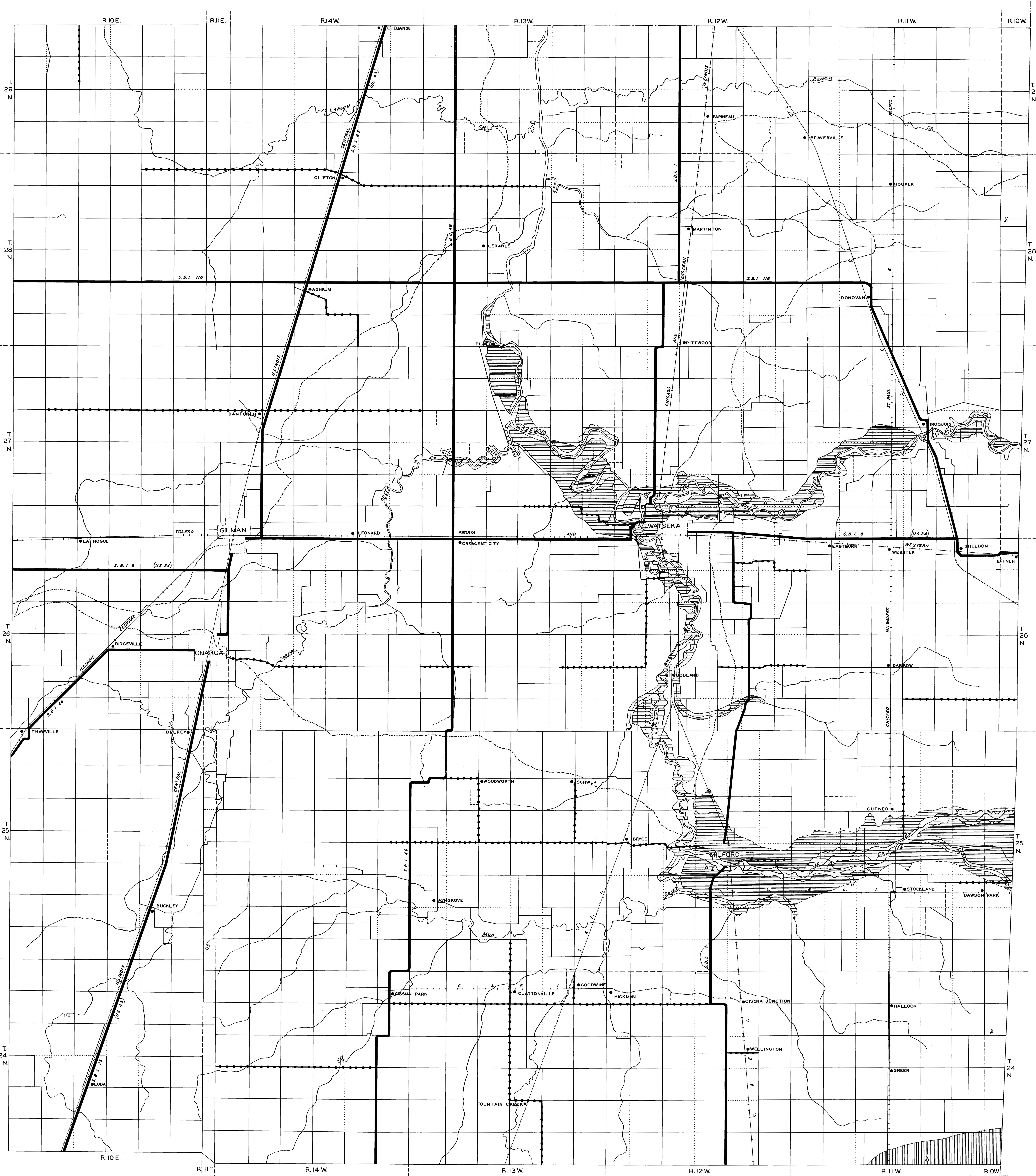

LEGEND

- | | | | |
|----------------------------|---|---|-----------------|
| — STATE BOND ISSUE HIGHWAY | ✕ PITS, ACTIVE | ▨ OUTWASH DEPOSITS OF GRAVEL, SAND, AND SILT CAPABLE OF DEVELOPMENT OR GOOD PROSPECTS | — STATE LINE |
| — PUBLIC ROAD PAVED | ✕ PITS, ABANDONED | ▨ TERRACE DEPOSITS OF OUTWASH SAND AND GRAVEL | — COUNTY LINE |
| — PUBLIC ROAD | — DEFINITE GEOLOGICAL BOUNDARY | ▨ GRAVEL DEPOSITS IN DRIFT, POSSIBLE PROSPECTS | — TOWNSHIP LINE |
| — SECONDARY ROAD | — INDEFINITE GEOLOGICAL BOUNDARY | ▨ ALLUVIUM PROBABLY UNDERLAIN BY OUTWASH DEPOSITS | — SECTION LINE |
| | — OUTER BOUNDARY OF AREA IRREGULARLY COVERED BY SAND, DUNIC IN EASTERN PART | | — CITY LIMIT |

SCALE



ILLINOIS STATE GEOLOGICAL SURVEY
 GEOLOGY BY V. H. JONES