

OIL AND GAS DEVELOPMENT MAP, BEECHER CITY AREA

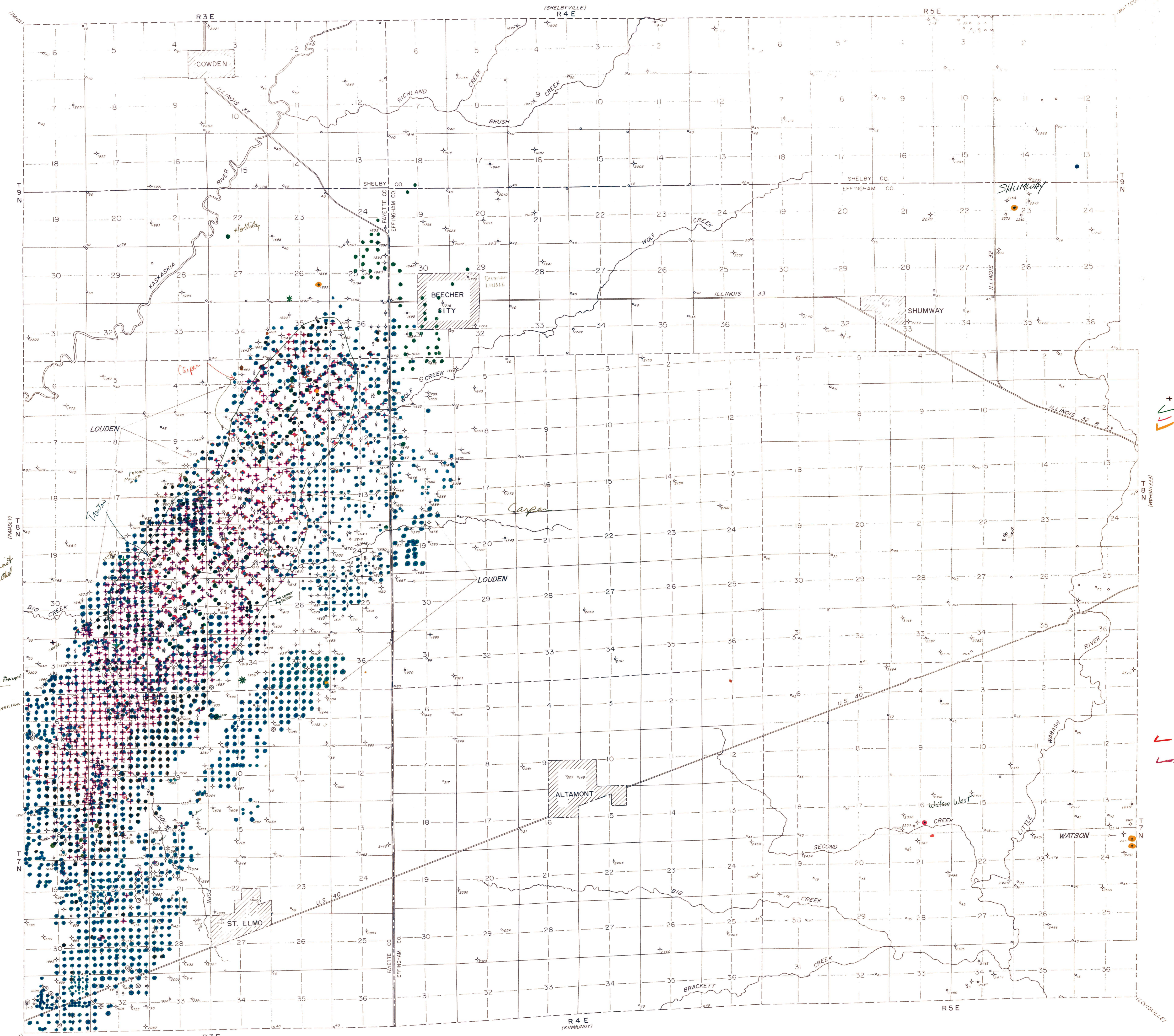

*Scientific Record - Research
PC, etc. - Record*

*310000 wells
10-19-82
10-19-82*

Carper - preliminary 6 wells (10-19-82)

Gas storage in Devonian

*Revised 12-2-76
1-1-83
12-3-87*

- PENNSYLVANIAN - 329
- TMA SPRINGS - 346
- CYPRESS - 343
- DENNETT - 343
- DENNETT - 346
- ANAVATES - 381
- ST. GENEVIEVE - 373
- ST. LOUIS - 340
- CARTER
- DEVONIAN - 375
- TRENTON - 745
- Permian - 751

- OIL WELL
- DISCOVERY WELL (AND DEPTH)
- ABANDONED OIL WELL
- GAS WELL
- ABANDONED GAS WELL
- DRY HOLE (AND DEPTH)

- ⊕ DRY HOLE, SHOW OF OIL
- ⊕ WATER INPUT WELL
- ⊕ OIL WELL CONVERTED TO WATER INPUT WELL
- ⊕ GAS WELL CONVERTED TO WATER INPUT WELL
- ⊕ DRY HOLE CONVERTED TO WATER INPUT WELL
- ⊕ SALT WATER DISPOSAL WELL CONVERTED TO WATER INPUT WELL

- ⊕ GAS INPUT WELL
- ⊕ COMBINATION OIL AND SALT WATER DISPOSAL WELL
- ⊕ OIL WELL CONVERTED TO SALT WATER DISPOSAL WELL
- ⊕ DRY HOLE CONVERTED TO SALT WATER DISPOSAL WELL
- ⊕ JUNKED HOLE
- ⊕ OTHER BORINGS (AND DEPTH)

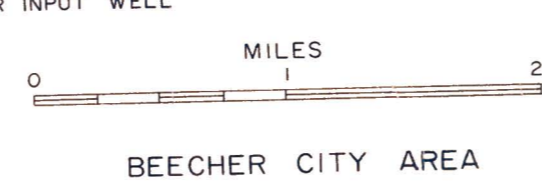

BEECHER CITY AREA